

1. First, mark the hole in the ceiling, then insert the expansion screw into the ceiling, then use the self-tapping screw to fix the ceiling. 1

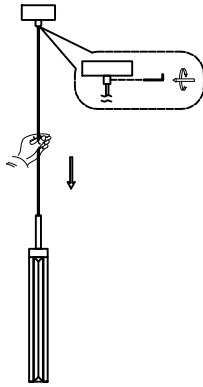

Insert the bulb into the bulb and test the electricity to make sure all the bulbs are working. Pay attention to your safety when testing the power. Lock the lamp shade again. 2



Loosen the screws on the lockstitch and adjust the length of the thread to the floor height. 3

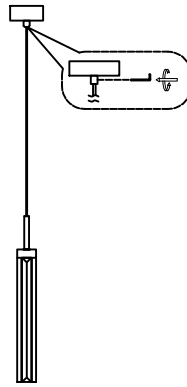

Tighten the screws on the sewing machine. 4

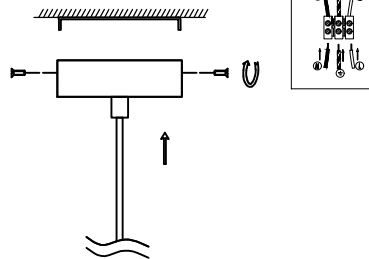

As shown in the picture on the right, connect the main line to the power cord on the ceiling (Note: When connecting, the main switch should be closed), then lock the suction top plate on the panel and turn the main switch on to test the power. 5

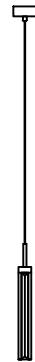

Installation complete. 6

Model: 4521L/S



Safety precautions:

1. The power do not exceed the prescribed range (rated voltage AC220-240V 50Hz).
2. Please cut off the power supply while replacing the light source and other maintenance operation .
3. The plate fixed on the ceiling must be able to withstand the weight more than 3 times of the object.
4. After installation is complete, check the glass right or not? If it is damaged, it should be replaced immediately.